

BELGARD GARDENS

Landscape Design Rationale Report

PHASE ONE

RP01 December 2018

LANDSCAPE

Landscape and Open Space

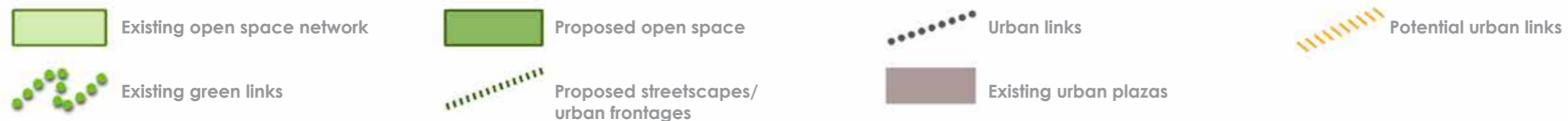

Landscape Design Statement

The layout, provision and design of the landscape and open space has had regard to:

- The setting of the site at a pivotal location north of Tallaght Town Centre, east of Tallaght Hospital to and west of IT Tallaght;
- Its function in extending the existing urban structure north of Belgard Square;
- The extent, nature, and scale of the proposed development – and the vision for of an appropriate landscaped environment for ‘Belgard Gardens’; and
- The opportunity for provision of high quality public realm, public space and landscape setting.

LEGEND	
HARD SURFACES:	
	Shared table
	Tarmac road surface
	Paving paving
	Courtyard paving
	Footpath paving
	Feature paving bands
	Paved cycle paths
	Cycle paths
	Paving sets
	Paving ties
	Rein bound paving
	Wet pour play surface
	Creche play area
SOFT LANDSCAPING:	
	Existing trees retained
	Proposed avenue trees
	Proposed street trees
	Proposed courtyard trees
	Grass - communal courtyards
	Proposed shrub planting
	Proposed shrub planting 1
	Proposed shrub planting 2
	Proposed ornamental grasses mix 1
	Proposed ornamental grasses mix 2
	Proposed floral mix
OTHER:	
	Apartment railings/balustrade to architects detail
	Proposed 1.9m flat bar railing proposed along Belgard Road boundary
	Proposed 1.2m high bowtop railing surrounding play areas
	Mounding
	Proposed benches
	Proposed communal seating areas
	Proposed raised planting beds
	Proposed play equipment (supported by fence or similar structure)
	Proposed play house
	Proposed seesaw
	Proposed horse springer
	Proposed lighting standards
	Proposed rental bike parking (front of students accommodation building)



Overall Belgard Gardens Landscape Masterplan Phase One

Landscape Design Statement

PUBLIC REALM AND OPEN SPACE:

The landscape design includes for provision of measures across all levels of the scheme and throughout the site, including:

- STREETSCAPE:** c.7,442sq.m incorporating wide footpaths and cycle lanes, tree planting, sustainable urban drainage, high-quality paving, cycle parking and seating. Belgard Square North is approximately 4,000sq.m in area.
- CIVIC PLAZA:** c.2,366sq.m of new civic plaza offering space for a wide range of uses (outdoor cinema, markets, sports, amenity and recreation) as well feature tree planting, high-quality paving, feature lighting and seating. As part of sustainable urban drainage strategy, the plaza also provides for long-term flood storage (for up to a 1 in 100 year storm). The attenuation has been positively integrated into the layout providing for a lowered games area surrounded by amphitheatre style terracing with seating.
- SEMI-PRIVATE COMMUNAL COURTYARDS:** c.5,516sqm at ground and podium levels for residents of the proposed apartment blocks. These areas include for both hard and soft landscape, communal seating, small elements of play, and tree and shrub planting.
- INTENSIVE GREEN ROOFS:** c.1,610sq.m located on 4th floor roof terraces. These areas include diverse soft landscaping promoting species diversity in both tree and shrub planting.
- EXTENSIVE GREEN ROOFS:** c.2,540sq.m on upper levels. Whilst not publicly accessible these landscaped areas add to the overall environmental, sustainable urban drainage systems and landscape structure of the development.
- HARDSCAPE MAINTENANCE ROOFS:** c. 1,438sq.m on upper levels. Not publically accessible, these areas provide access and maintenance to residential units and are of a hard surface.

Breakdown of Public Realm and Open Space per Phase 1:

PHASE ONE

Streetscapes:	7,442sq.m
Civic Plaza:	2,366sq.m
Residential & Student Courtyards:	5,516sq.m
Intensive Green roofs:	1,610sq.m
Extensive Green roofs:	2,540sqm
Hardcape Maintenance Roofs:	1,438sqm

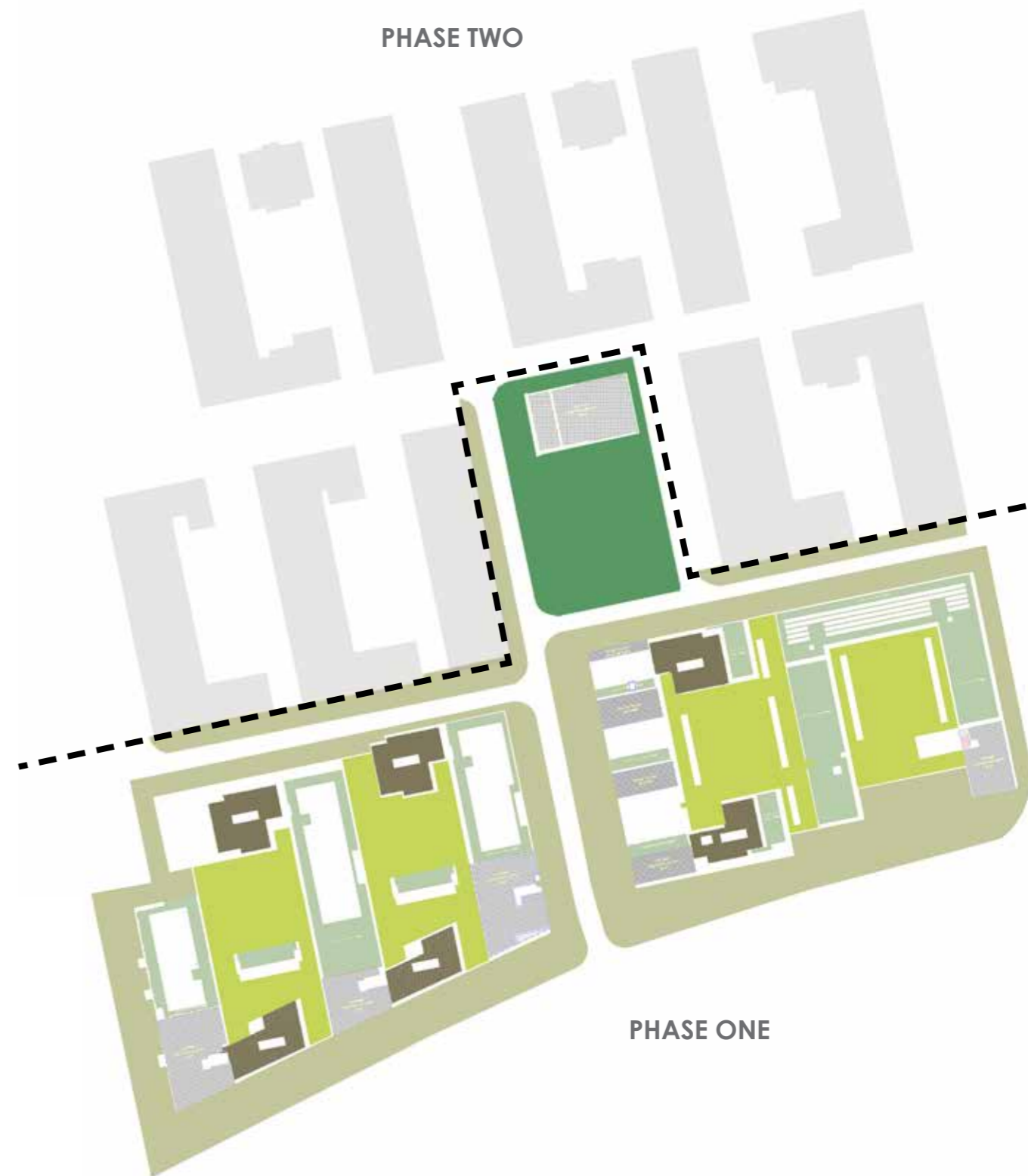

Public Realm and Open Space Categorisation

Landscape Character Areas: Civic Plaza

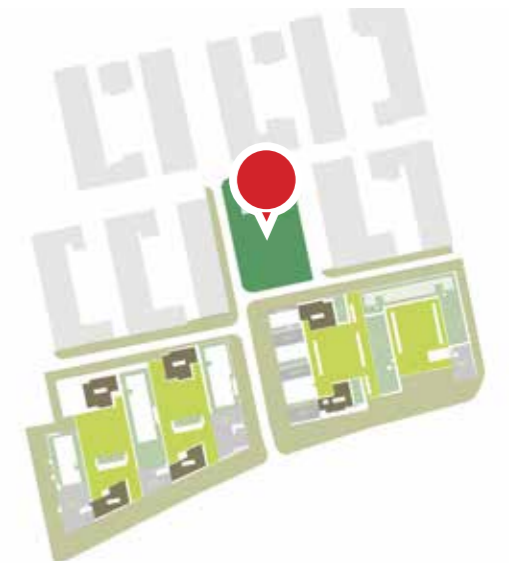

Location Plan



Section A-A Scale 1:100



Section B-B Scale 1:100



Section C-C Scale 1:100

PRECEDENT EXAMPLES: Potential Indicative Flexible Uses at the Civic Plaza



Banlitun Village Beijing Shopping



Mariahilferstrasse, Vienna, Austria



Szell Kalman Square, Budapest, Hungary



Cambridge Night Market & Open Air Cinema, Cambridge, UK



Sundance Square Plaza in Fort Worth, Fort Worth



Waterplein Bentheplein, Rotterdam

Landscape Character Areas: Belgard Square North

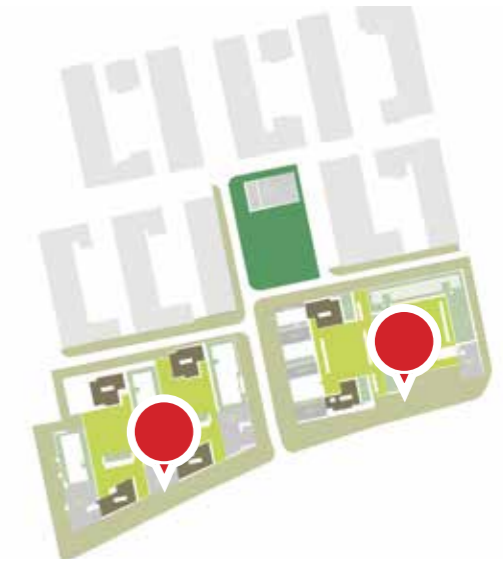

Location Plan

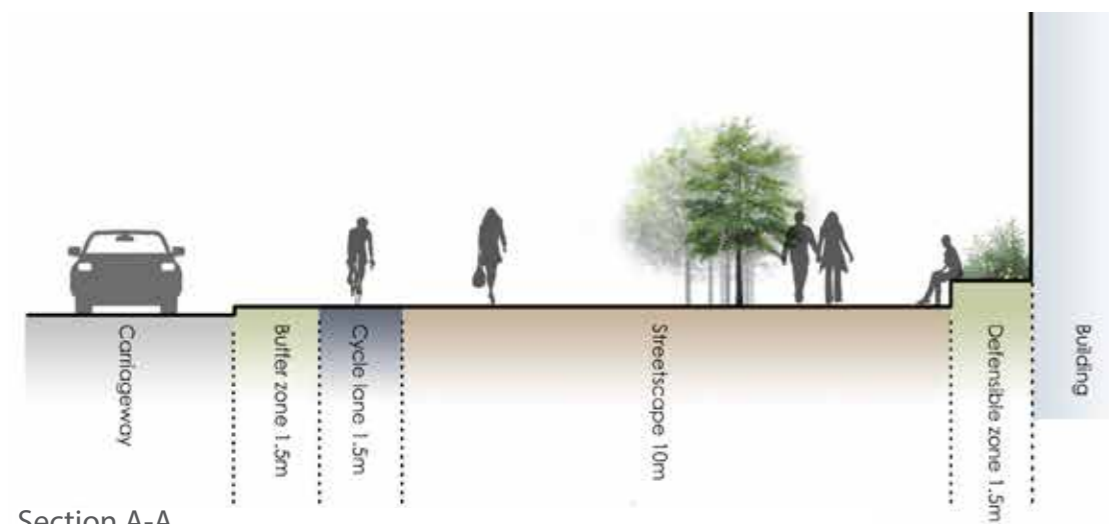

Section A-A
Belgard Square North (Western Frontage)

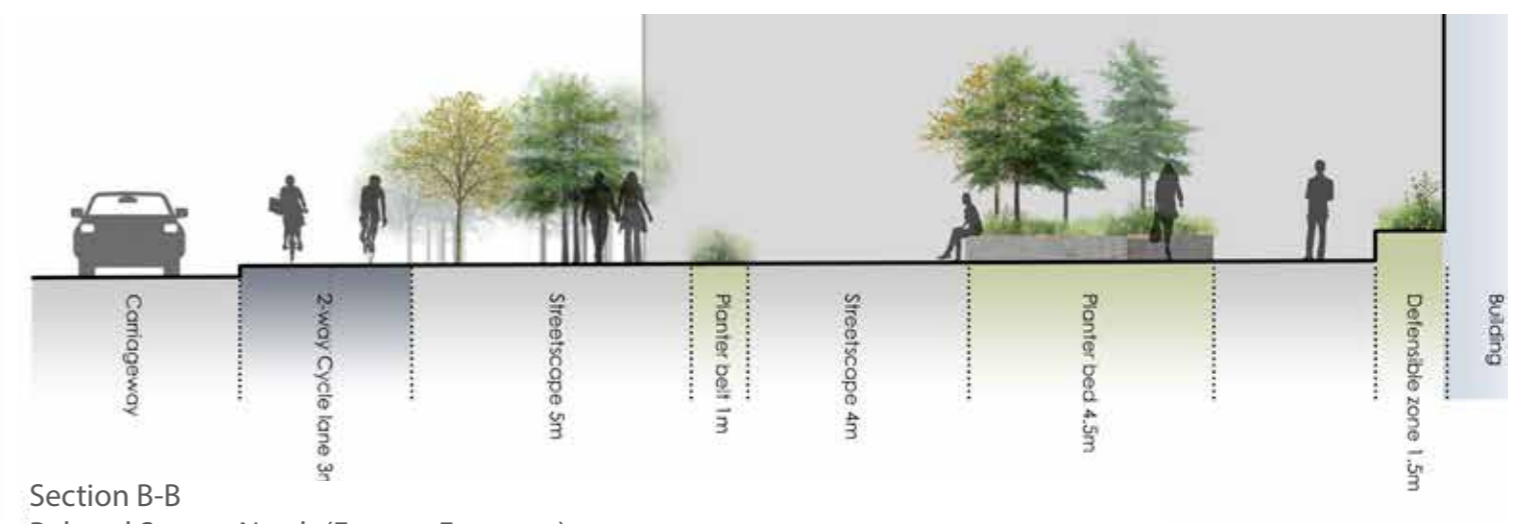

Section B-B
Belgard Square North (Eastern Frontage)

PRECEDENT EXAMPLES: Indicative Bespoke Public Realm Quality



Landscape Character Areas: Belgard Square North

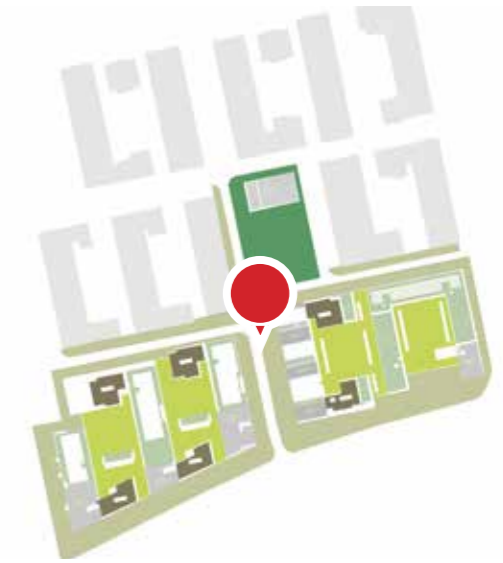

Location Plan



Section M-M
Main Entrance Road

PRECEDENT EXAMPLES: Indicative Bespoke Public Realm Quality



Landscape Character Areas: Residential Courtyard



Example of Residential Courtyards

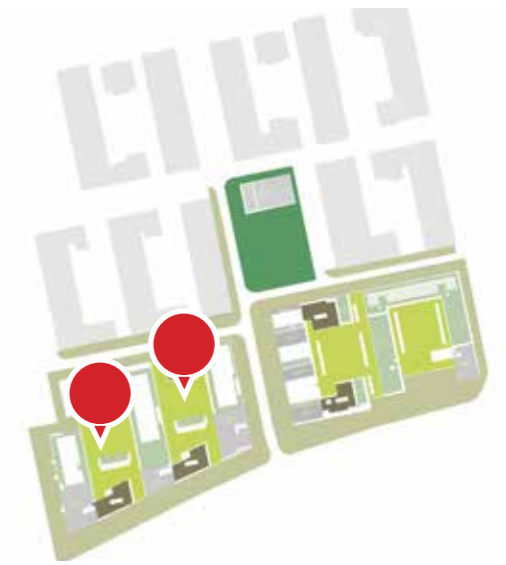

Location Plan



PRECEDENT EXAMPLES: Indicative Types and Variety within Residential Courtyards



Landscape Character Areas: Student Courtyard

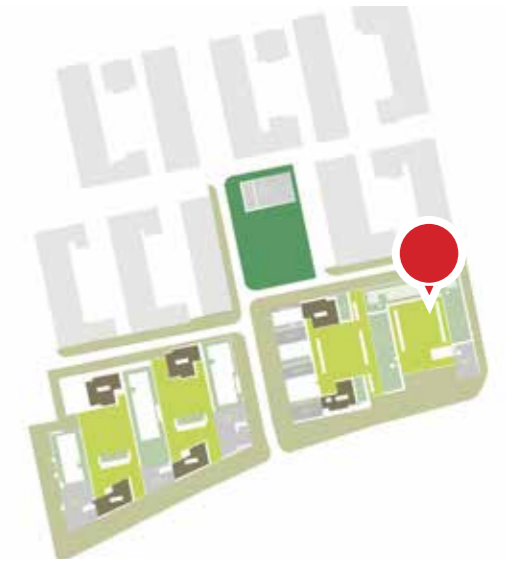

Location Plan



PRECEDENT EXAMPLES: Indicative Variety and High Quality Materials and Public Realm

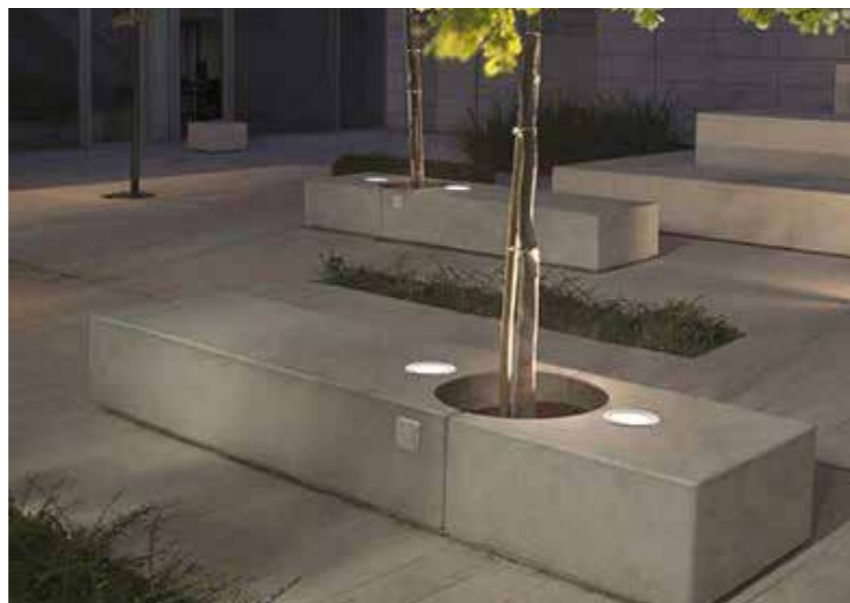

Landscape Character Areas: Intensive Green Roofs

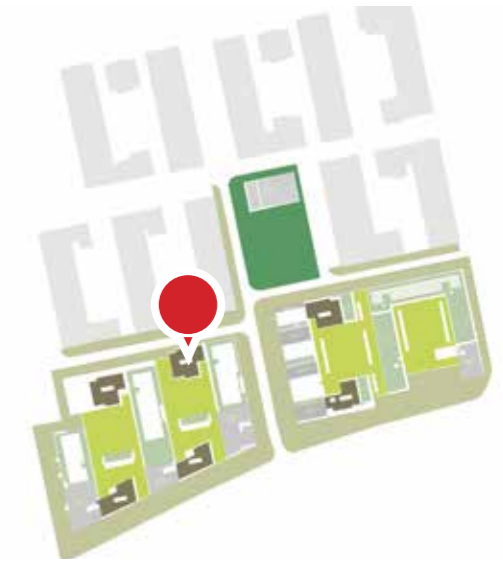

Location Plan



Amenity Green Roof Type 1

Amenity Green Roof Type 2

PRECEDENT EXAMPLES: Indicative Amenity Green Roof Types and High Biodiversity Environments



Proposed Tree Planting

